

# YOUR OFFER OF ACCOMMODATION

## Kaplan Living Liverpool

Feel at home in this new student residence in Liverpool. It's just a stone's throw from a great range of amenities and a short walk from the University of Liverpool.



### Student living to suit you

A range of living options (bills included) plus social and study spaces you won't want to miss.



### We're here for you, AM to PM

Locked out or need to talk? Our support teams are here to help – whenever you need it.



### 39 Week Contracts

All students living in Kaplan Living Liverpool will be on a 39 week contract which will finish in line with 1st year course duration.

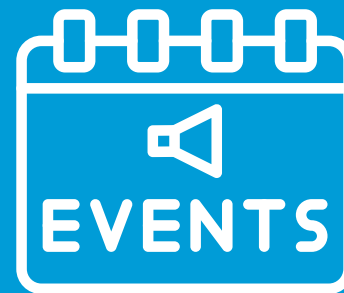

### Social Events

You won't have to miss your favourite shows as you'll have access to a TV lounge, as well as a games room and comfy social spaces where you can relax with your new friends. The residence also organises social events throughout the year, so you'll always have something fun to do!

**Kaplan Living Liverpool are the University of Liverpool Preferred Private Provider.**

**If you receive an offer for accommodation with our University Approved Private Providers, the contract will be with the provider themselves and not the University of Liverpool.**

# Kaplan Living Liverpool



This comfortable and welcoming accommodation has everything you need to help you feel at home from the moment you arrive in Liverpool

You'll be in a great location at Kaplan Living Liverpool, it is located just a few minute walk to the University of Liverpool Campus (Opposite Crown Place) and is only a short distance to the city center.

This purpose-built student accommodation has all the facilities you need for a successful study experience, including a study lounge as well as a laundry room and bicycle storage.

You won't have to miss your favourite shows as you'll have access to a TV lounge, as well as a games room and comfy social spaces where you can relax with your new friends. The residence also organises social events throughout the year, so you'll always have something fun to do!

The friendly, on-site customer services team is here to support you 24/7 – your safety and wellbeing is a top priority.



## Kaplan Living Liverpool Includes:



High speed Wi-Fi



Bike storage



Maintenance team



Contents insurance



Communal lounge



Secure Deposit



Study and social spaces



On-site laundry facilities



Parcel receipt service



Staff on-site 24/7



Social calendar

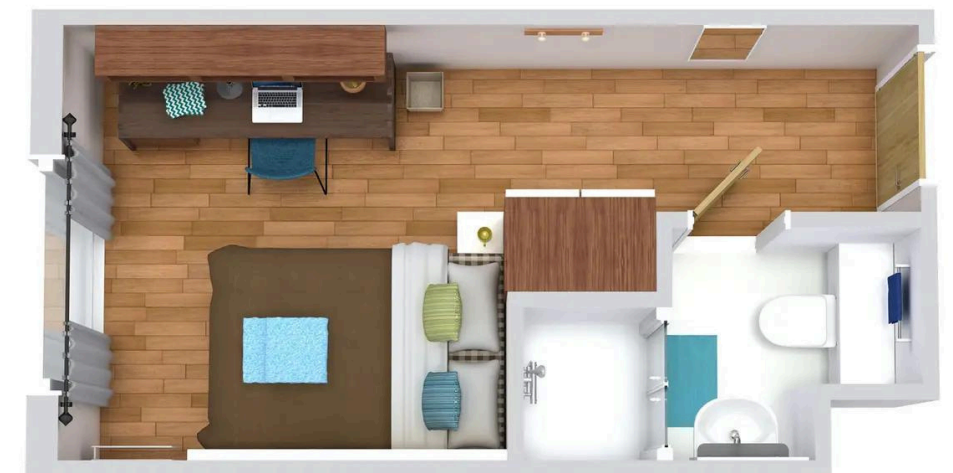

**If you receive an offer for accommodation with our University Approved Private Providers, the contract will be with the provider themselves and not the University of Liverpool. The offer received will only be a recommendation and you are not obliged to book accommodation with Kaplan Living Liverpool . By booking with Kaplan Living you will be doing so at your own risk and agreeing to the terms and conditions of the tenancy agreement/license that you sign into.**

# So how does the process work?

Here's a round-up of things to complete to secure your room!

**Step 1** To book with Kaplan Living please begin your booking through the specific link sent to you by the University of Liverpool

**Step 2** When they contact they will require you to pay a deposit of £250 and you will be required to provide a UK guarantor if you wish to pay in instalment. Your offer will be valid for 24 hours after it has been sent.

**Step 3** Whilst we ensure that Kaplan Living provides you with the above benefits, it is your choice to secure accommodation at this location. You will be required to sign up to a legally binding Tenancy Agreement and we strongly advise you read through the Terms and Conditions before signing. Your Tenancy Agreement will be with Kaplan Living, not the University of Liverpool.

**Step 4** After you book, you should then receive all the information you need to prepare for your move into your brand-new home away from home.

